

CVX-OPTS\_Manual\_260610

# Cypress CVX-OPTS Intelligent Wiegand Splitter - Specifications

Electrical and Mechanical Specifications		
Physical	Enclosure Dimensions:	4.18" x 2.875" x .75"
	Board Dimensions:	4.09" x 2.34" x .4375"
Environmental	Storage Temperature:	-55°C to + 150°C
	Operating Temperature:	-40°C to +80°C
	Enclosure:	Extruded aluminum, not sealed or weather rated
Humidity	95% (non-condensing)	
Power	Input	Unreg Input 8 to 16 VDC* @ 200mA Max
	Output	+5VDC @100mA
Data I/O	Interface	Reader -Wiegand

The CVX-OPTS units should be operated with a filtered 12 Volt nominal DC supply. Any voltage between 8 and 16 volts can be utilized by following the temperature / voltage derating curve. Voltage should not exceed 16 VDC under normal operating conditions.

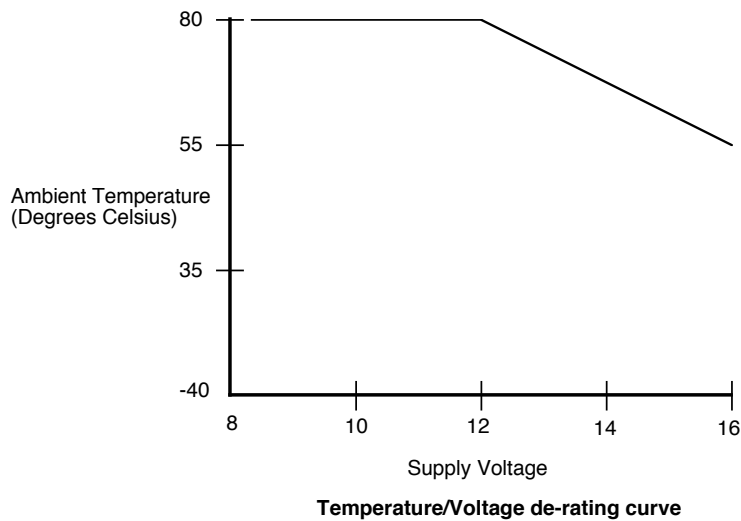

## FCC Part 15 COMPLIANCE

This device complies with part 15 of the FCC Rules.

Operation is subject to the following two conditions:

- (1) This device may not cause harmful interference, and
- (2) this device must accept any interference received, including interference that may cause undesired operation.

# Cypress CVX-OPTS Intelligent Wiegand Splitter - Table of Contents

<b>Table of Contents</b>	
<b>Topic</b>	<b>Page</b>
Specifications	2
Voltage Note, Temperature–Voltage Derating Curve	2
Conversion Description	4
Physical Dimensions and Mounting Holes	4
Wiring Diagram	5

# Cypress CVX-OPTS Intelligent Wiegand Splitter - Conversion, Dimensions, Mounting

Signals from one (1) Wiegand reader are split based on one of the following criteria:

1. Site code
2. Bit count

**Note:** Must be identified at time of order. Once units are programmed they cannot be modified in the field.

## Example 1

Badge population includes 26 bit , 37 bit and Corp 1000.  
Panel 1 only receives Corp 1000 reads and Panel 2 receives all others

## Example 2

Badge population includes all 26 bit badges, with site codes of 123 and 50.  
Panel 1 only receives Site code 123 reads and Panel 2 receives only site code 50.

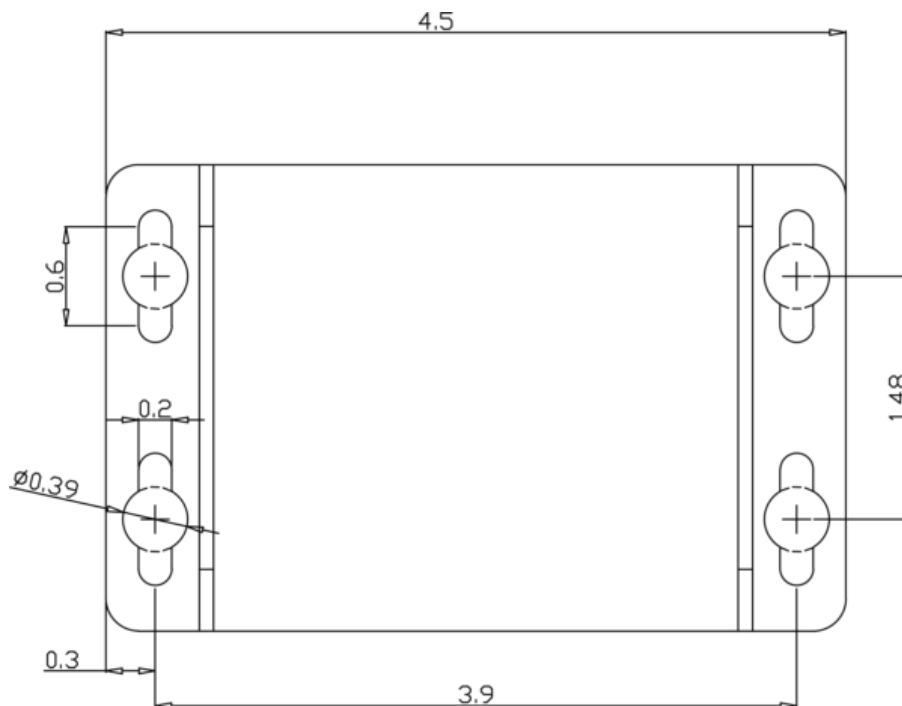

## Physical Dimensions and Mounting Hole locations

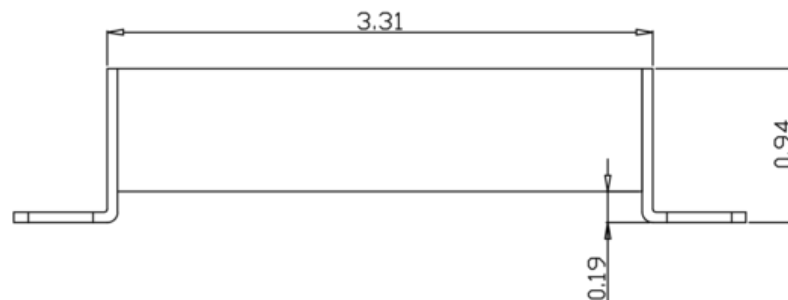

# Cypress CVX-OPTS Intelligent Wiegand Splitter - Wiring Diagram

**Wiring Diagram:  
Wiegand-to-Wiegand, One Reader, Two panels**

