

- The Cypress OSMIUM OSDP-Ethernet Bridge securely connects IT and access control by bridging SIA's Open Supervised Device Protocol (OSDP™) and the internet
- Use the Bridge to connect a reader to an access control system via Ethernet
- Securely manage an access control point with a host computer control program
- Also available: The OSM-5010 OSDP-Ethernet Bridge with general I/O control for door control and monitoring devices.



Specifications			
Ordering Information	OSM-5000	UPC: 816684001611	OSMIUM Series OSDP-Ethernet Bridge
OSDP Version	Open Supervised Device Protocol (OSDP™) v2.1.7		
Physical	4.50" x 3.07" x 2.02" / 0.445 lbs		
Environmental	Storage Temperature	-40°C to 100°C	
	Operating Temperature	-30°C to 60°C	
Electrical	Supply Voltage	8-16Vdc Current 300mA	
Cable Requirements	Ethernet Connection	CAT 5E Cable	
	OSDP	22 AWG Shielded Twisted Pair	
	I/O	22 AWG	



OSM-5000_180924

Features

Small footprint: Single-chip, fault-tolerant OS solution with pluggable terminal block wiring

Low power: Allows for parasitic, PoE, battery, or solar power

OSDP v2: Fully implemented Secure Channel on RS-485 and Ethernet ports for data integrity, standards-based encryption and authentication, as well as key management

Web server: Embedded, secure, platform-agnostic web server is and compatible with any browser for configuration testing; no special app or tool is required

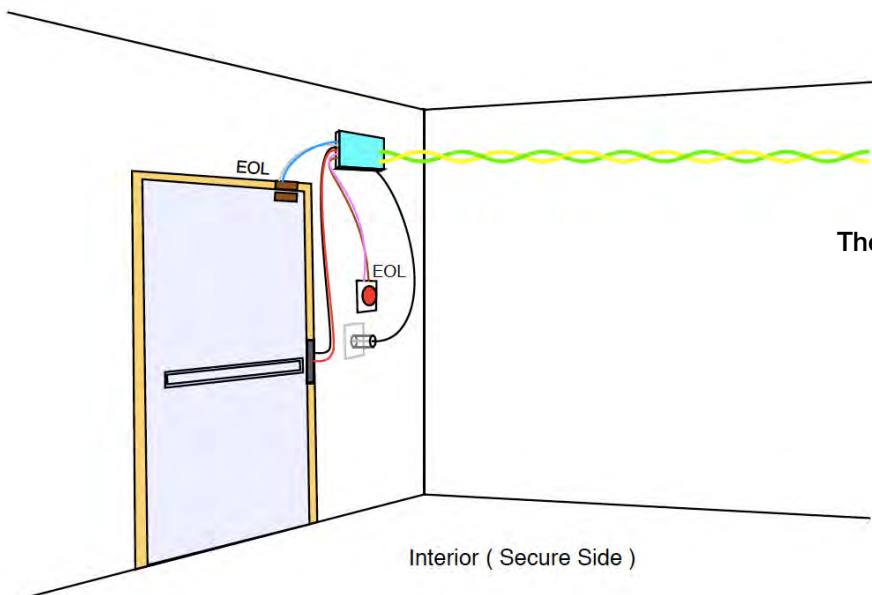
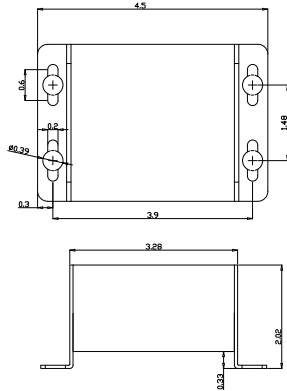

The OSDP-Ethernet Bridge converts from 802.3 to RS-485. All information is stored in the Control Panel. Secure Channel is handled directly between the Control Panel and Peripheral Devices.

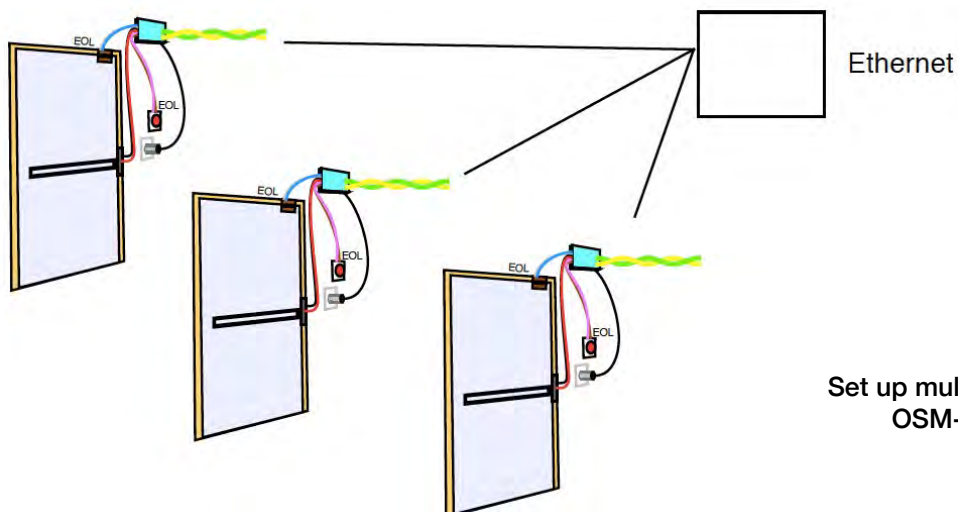

Set up multiple OSDP devices using a single OSM-5000 OSDP-Ethernet Bridge